

CABLEWAY TROLLY & PENDLUM SEAT

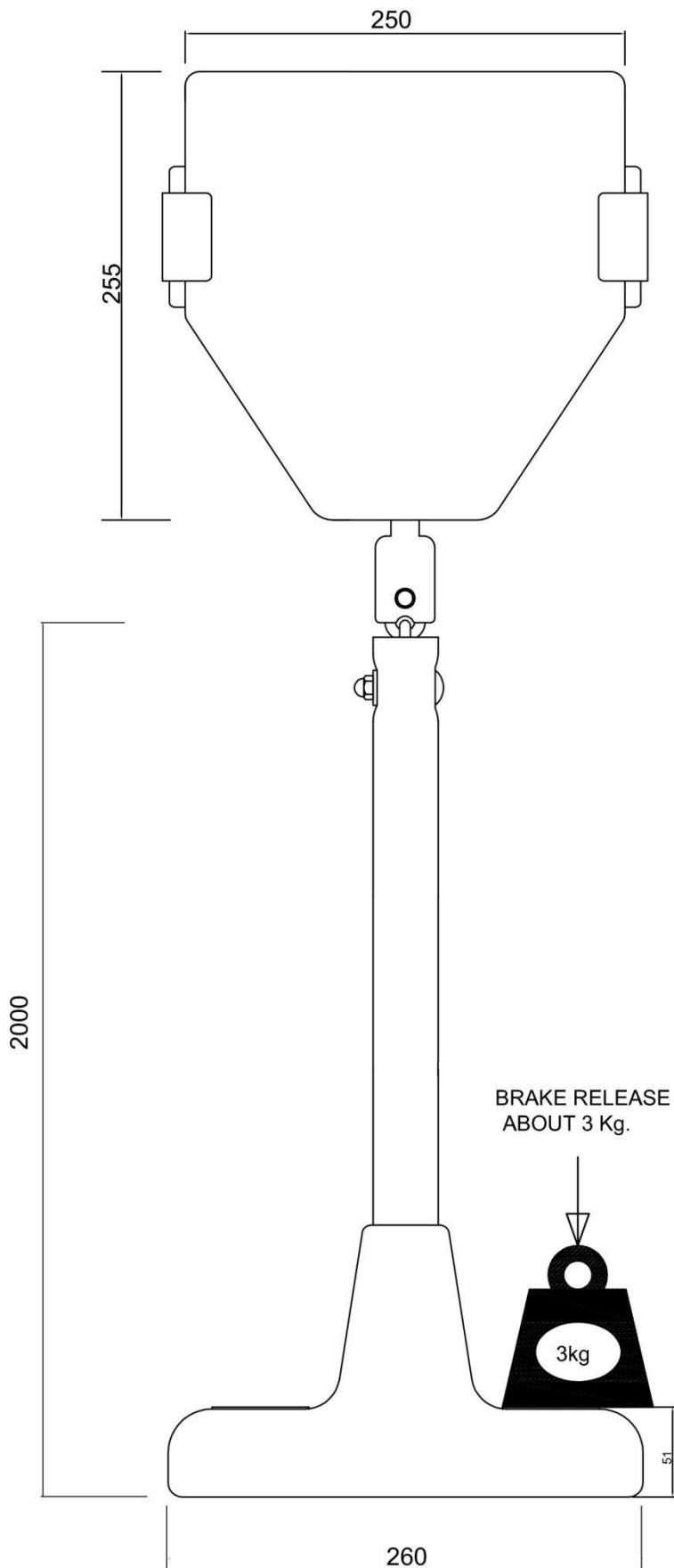

GB - When the R&T pendulum seat is connected to the R&T cableway trolley – the user must apply a weight load/force of approximately 3,0 kg to the pendulum seat in order to release the brake in the trolley.

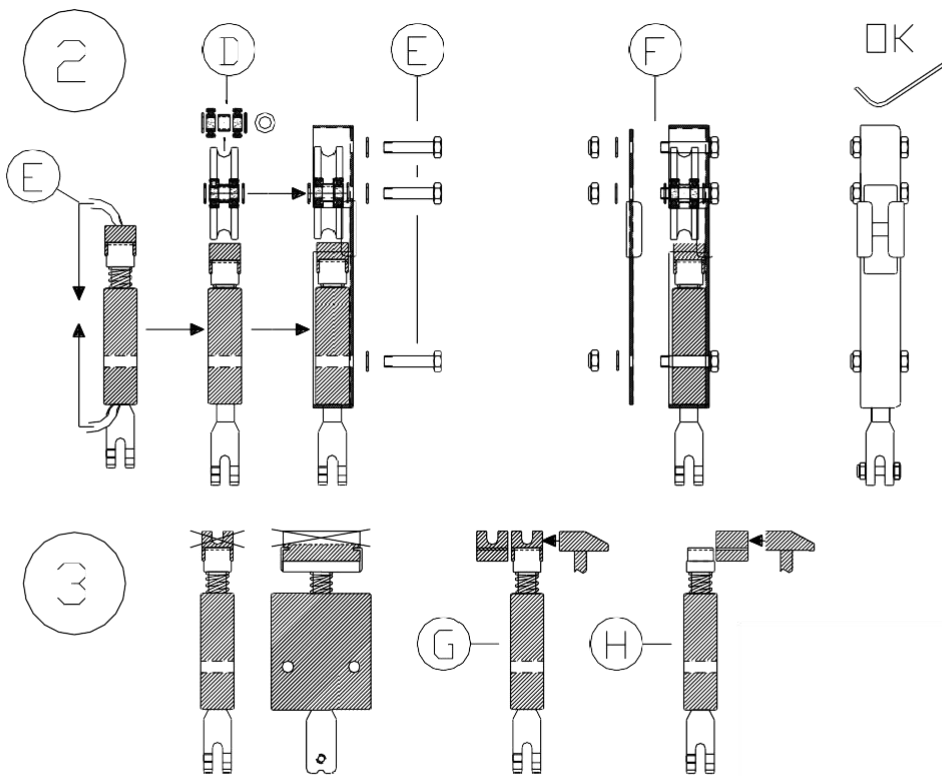
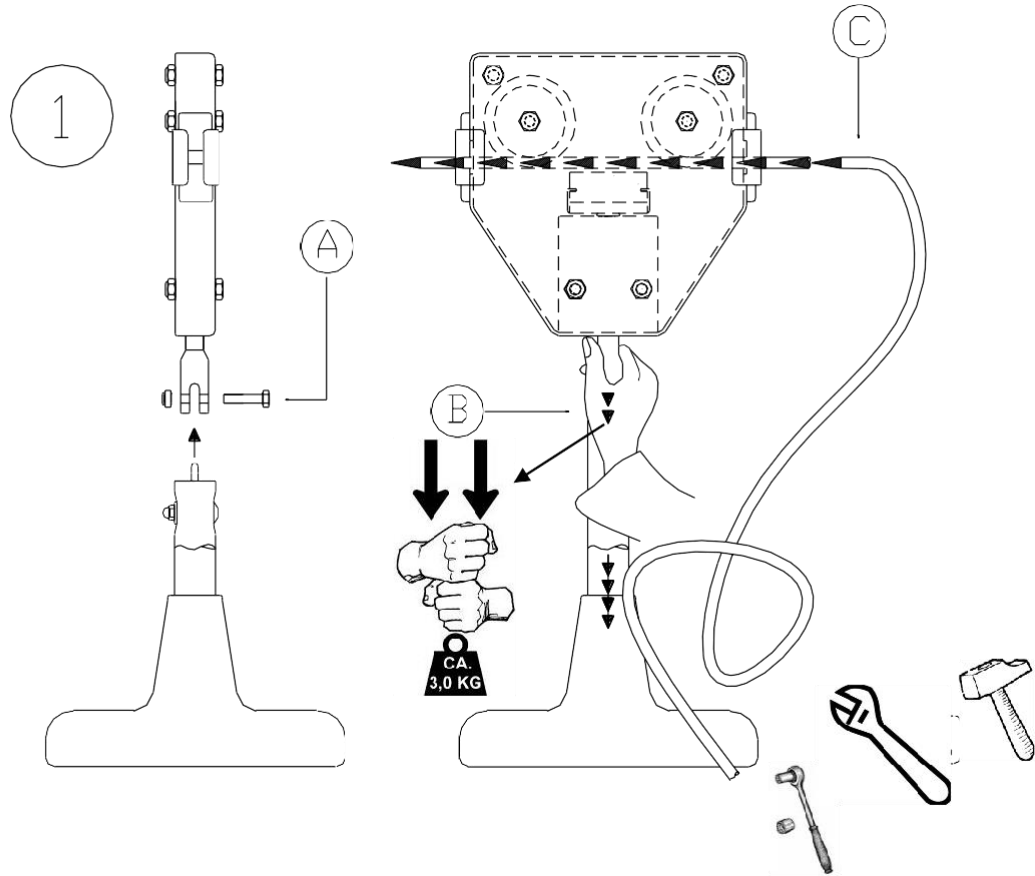

Cableway Installation Instructions

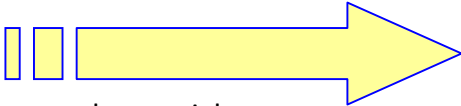
- Prior to mounting of the Cable Tensioner and the Counter Part, please drill the holes in your crossbeam.
- Mount the Cable Tensioner and the Counter Part. Both must be mounted on the backside of the crossbeam.
- Mount the cable to the Counter Part. The cable must go through the Counter Part and the crossbeam. Secure the thimble of the cable to the Counter Part by means of a bolt and nut.
- Install Break Spring for end section. Cable must through Break spring.
- Mount the Pendulum Seat to the Trolley.
- Step on the chain of the Pendulum Seat and pull the Trolley upwards, this in order the release the break of the Trolley.
- Insert the Cable through the Trolley. 
- Take of the Pendulum Seat – in order to reduce weight.
- Install Break Spring for start section. Cable must through Break spring.
- Mount Cable to the Cable Tensioner.
- Mount Pendulum Seat to the trolley.
- Now use the cable Tensioner, in order to tension the cable properly.
- Now that the cable is in the correct position, secure the wire locks of the Break springs, at the correct positions.



After mounting please inspect the complete system, making sure that the installation meets all requirement in EN 1176.

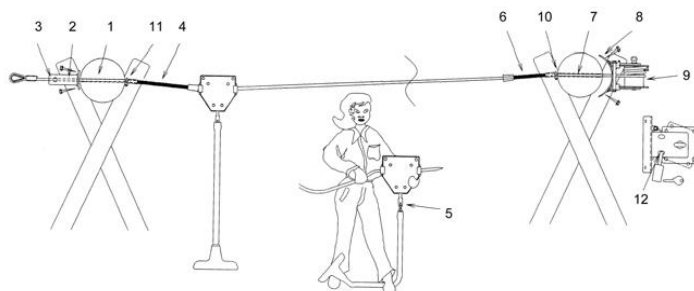

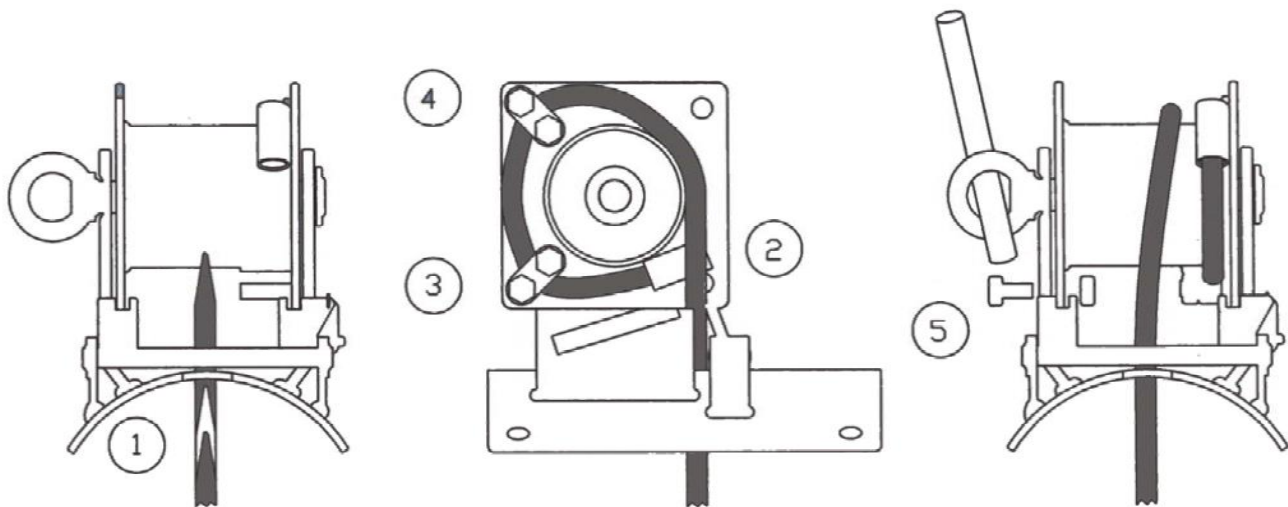

1. Insert the end of cable through the hole and into the cable housing.
2. Open wire clamp and put cable in, close wire clamp.
3. Turn the ratchet with one “click” and repeat step no.2.
4. Turn the ratchet with one “click” and fasten all nuts on the wireclamps.
5. Turn the ratchet until required tension on the cable is achieved and secure with nut and bolt, thereby finishing the installation.